

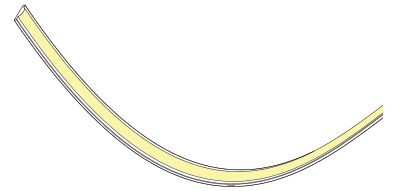

Fixture Cross-Section
(enlarged to show detail)

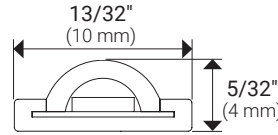

24V

Ordering Information

400 Lumens/ft. 24-Volt, Single-White Top Bend LED Neon Flexible Lighting

| Width | Kelvin Temperature | Length | Lumens Per Foot | Watts Per Foot | IP Rating | Cutting | Part Number |
|-------|--------------------|--------|-----------------|----------------|-----------|-----------------|-----------------|
| 10 mm | 3000K, 4000K | 16 ft. | 400 | 3.8W (12/m) | IP66 | Approx. 1-5/16" | LN4T1W24016Temp |



24V

Ordering Information

225 Lumens/ft. 24-Volt, Single-White Top Bend LED Neon Flexible Lighting

| Width | Kelvin Temperature | Length | Lumens Per Foot | Watts Per Foot | IP Rating | Cutting | Part Number |
|-------|--------------------|--------|-----------------|----------------|-----------|------------|-----------------|
| 10 mm | 3000K, 4000K | 16 ft. | 225 | 3.6W (11.5/m) | IP66 | Approx. 1" | LN2T1W24016Temp |



24V

Ordering Information

120 Lumens/ft. 24-Volt, Single-White Top Bend LED Neon Flexible Lighting

| Width | Kelvin Temperature | Length | Lumens Per Foot | Watts Per Foot | IP Rating | Cutting | Part Number |
|-------|--------------------|--------|-----------------|----------------|-----------|------------|-----------------|
| 10 mm | 3000K, 4000K | 16 ft. | 120 | 2W (6.3/m) | IP66 | Approx. 1" | LN1T1W24016Temp |

About The Product

- Flexible, silicone casing with top-bending (vertical) direction
- Achieve the continuous lighting aesthetics of neon lighting with the benefits of LED lighting
- Slim profile for surface-mount application—ideal for frameless cabinetry or shelving
- Low profile allows for in-cabinet installation without modifying shelving
- 7" lead wire from factory; Easy to cut and reconnect in the field
- Double-side adhesive on the back for easy installation
- 2 Loop Mounting Clips included with each roll for wire management at ends of lighting (additional clips sold separately)
- Accessories sold separately: end caps and connectors
- Waterproof IP66 rating for indoor/outdoor applications
- Plug-in or hardwired power supply required (order separately)
- No Ultraviolet (UV) or Infrared (IR)
- Compatible with smart home devices (not sold by Task Lighting); WAV Smart Control™ required (order separately)

Applications

Under cabinets or shelves

Curved surfaces

For additional application help and suggestions, call Design Services at 866-848-9094

Available Kelvin Temperatures



Smart home
Compatible



Technical Information

| | |
|------------------------------------|---|
| Input Voltage | 24-volt DC |
| Color Temperature (Kelvin) | Soft White 3000K (30) Cool White 4000K (40) |
| CRI (Color Rendering Index) | 90+ |
| LED Type | SMD 2835 |
| Lumens | 120, 225, 400 lumens per foot |
| Max Run | Recommended maximum run length is 16 ft. (5 m) for single-side powering. For longer runs, power from both ends of the lighting. |
| Dimmable | 5%–100% |
| Rated Life | 50,000 hrs |
| LED Beam Angle | 120° |
| Diodes per Foot | 72 |
| LED Spacing | approx. 3/16" (4.17 mm) |
| Bend Diameter | R>1-3/16" (R>30 mm) |
| Mounting | Waterproof adhesive tape on back of lighting strip, bottom mounting clips or loop mounting clips (order separately) |
| Wiring | 20/2 stranded or solid |
| Operating Temperature | -40°F to 131°F (-40°C to 55°C) |
| Environment | Damp, wet, dry locations |
| Construction Material | Heat resistant 8 mm PCB, Silicone enclosure (yellowing, UV, salt and alkali, high temp, flame resistant). |

Lumen Output Options



ACCENT



STANDARD



HIGH

Mounting Clips Recommended to use approximately every 24"—36"

| Description | Dimensions | Part Number |
|--|-----------------------|-------------|
| Bottom mounting clip; clear plastic | 1/2" x 7/32" x 9/16" | L-NT-BMC-C |
| Loop mounting clip; clear plastic; NOTE: 2 pieces included with L-NT-L2W-W and L-NT-LC-W | 1/4" x 3/16" x 15/16" | L-NT-LMC-C |

Connectors and End Cap

| Description | Dimensions | Part Number |
|---|------------------------|-------------|
| Light-to-wire connector with screw-down connector; white; 2 L-NT-LMC-C included with each order | 3 ft | L-NT-L2W-W |
| Light-to-light connector; white | 5/8" x 5/16" x 1-7/16" | L-NT-L2L-W |
| 9-1/2" Linking cable; white; 2 L-NT-LMC-C included with each order | 9-1/2" (6-3/4" wire) | L-NT-LC-W |
| End cap; clear silicone | 3/8" x 1/4" x 3/8" | L-NT-EC-C |

Compatible Power Supplies NOTE: Task Lighting 24-volt power supplies rated for 100-watts and less are Class 2 Listed for residential use

| Description | Dimensions | Part Number |
|---|-------------------------------|-----------------|
| 24-watt, 24-volt, AC/DC 2 prong plug-in, 1-amp. Class 2 rated. | 2-15/16" x 1-3/16" x 1-13/16" | T-24V-24W-PI |
| 60-watt, 24-volt, AC/DC 2 prong plug-in, 2.5-amp. Class 2 rated. | 3-11/16" x 1-7/8" x 1-5/16" | T-24V-60W-PI |
| 96-watt, 24-volt, AC/DC 2 prong plug-in, 4-amp. | 5" x 2-1/4" x 1-1/4" | T-24V-96W-PI |
| 120-watt, 24-volt, AC/DC 2 prong plug-in, 5-amp. | 3-3/4" x 2" x 1-5/16" | T-24V-120W-PI |
| WAV Smart Receiver/96-watt plug-in power supply. Class 2 rated | 9-5/8" x 2-1/2" x 1-1/2" | T-TWAV24V96WPSR |
| 60-watt, 24-volt IP67 rated waterproof LED hardwired. Class 2 rated. | 6-3/8" x 1-5/8" x 1-1/4" | T-24-60W-WP-HW |
| 100-watt, 24-volt IP67 rated waterproof LED hardwired. Class 2 rated. | 7-3/8" x 2-3/8" x 1-1/2" | T-24-100W-WP-HW |
| 150-watt, 24-volt IP67 rated waterproof LED hardwired. | 7-1/2" x 2-1/2" x 1-1/2" | T-24-150W-WP-HW |
| 75-watt, 24-volt DC RF CV hardwired with built-in wireless receiver. | 8-1/2" x 4-1/2" x 1-1/4" | T-DQ75W-24V-HW |
| 30-watt, 24-volt, dimmable hardwired. Class 2 rated. | 6-1/2" x 1-5/8" x 1-1/4" | T-24V-DT30W-HW |
| 60-watt, 24-volt, dimmable hardwired. Class 2 rated. | 7-3/8" x 2-3/8" x 1-1/2" | T-24V-DT60W-HW |
| 120-watt, 24-volt, dimmable hardwired. Class 2 rated. | 7-1/4" x 2-7/8" x 1-5/8" | T-24V-DT120W-HW |
| 350-watt, 24-volt, indoor industrial harwired. | 8-1/2" x 4-1/2" x 1-1/4" | T-350W-24V-HW |

Compatible Dimming Systems

| Description | Dimensions | Part Number |
|--|------------------------------|-------------------------------------|
| One Zone LED controller. On/off/dim. Use with LED Receiver. | 2-5/8" x 1-5/16" x 3/8" | T-Q-1Z-WC-RF- Color |
| Two Zone LED controller. On/off/dim. Use with LED Receiver. | 2-5/8" x 1-5/16" x 3/8" | T-Q-2Z-WC-RF- Color |
| Four Zone LED controller. On/off/dim. Use with LED Receiver. | 2-5/8" x 1-5/16" x 3/8" | T-Q-4Z-WC-RF- Color |
| 96-watt receiver for single-white lighting. Use one receiver per zone and pair with a wireless controller. | 3-7/8" x 1-13/16" x 13/16" | T-Q-WR96 |
| 240-watt receiver for single-white lighting. Use one receiver per zone and pair with a wireless controller. | 7" x 1-13/16" x 7/8" | T-Q-WR240 |
| WAV 120-watt smart LED Receiver. Use with a Wireless Controller. | 4-1/4" x 2-1/4" x 3/8" | T-TWAV-WR-120 |
| Decora style cover plate to fit over Wireless Controller on wall. Available in Almond (AL), Black (BK), Brown (BR), Grey (GR), or White (WT). | 4-11/16" x 2-15/16" x 11/16" | T-DPL- Color |

Sensors and Switches

Sensors and switches must be wired before the wired controller or receiver to function properly.

| Description | Dimensions | Part Number |
|--|-------------------------------|-----------------|
| Infrared (IR) door sensor switch. | 3/8" x 1" x 1-1/4" | T-DSS-30W-IR |
| Infrared (IR) door sensor switch with two heads . | 3/8" x 1" x 1-1/4" | T-2HDSS-30W-IR |
| Doppler motion sensor switch | 3-7/8" x 1-13/16" x 13/16" | T-MSS-D-TS |
| Motion sensor switch. | 1/2" x 2-1/4" | T-MSS-60W |
| Infrared (IR) sensor proximity switch. | 2-1/4" x 3/8" | T-PSS-60W-IR |
| LED touch dimmer. | 3/8" x 2" x 2" | T-TDS-60W |
| Recessed LED touch dimmer. | 2-1/4" x 29/64" | T-TDS-R |
| Infrared (IR) wave sensor switch. | 2-1/4" x 3/8" | T-WSS-60W-IR |
| 600W Diva slide dimmer. Available in Almond (AL), Black (BK), Brown (BR), Grey (GR), or White (WT) | 4-11/16" x 2-15/16" x 1-5/16" | DVLV-600P-Color |
| On/off round switch. | 15/16" | T-RS-BK |

Connectors

| Description | Dimensions | Part Number |
|--|-------------------------------|----------------|
| 36" Barrel Connector Extender; black. | 3 ft. overall length | T-BC-EXT-36-BK |
| 72" Barrel Connector Extender; black. | 6 ft. overall length | T-BC-EXT-72-BK |
| 96" Barrel Connector Extender; black. | 8 ft. overall length | T-BC-EXT-96-BK |
| Female barrel to screw-down connector. | 1-9/16" x 9/16" x 1/2" | T-FBC |
| Male barrel to screw-down connector. | 1-9/16" x 9/16" x 1/2" | T-MBC |
| EZ wire-to-wire connector. | 13/16" x 11/16" x 5/16" | T-EZWC |
| DC 3-way splitter plug. | 16" overall; 8" length/splice | T-3WSP |
| White 9-amp wire distribution block. | 15/16" x 2-5/16" x 3/8" | T-WDB-W |
| White mini junction wire box. | 2" x 1" x 5/8" | T-JB-W |

Optional Components

| Description | Dimensions | Part Number |
|--|------------------------|----------------|
| 90" Plastic wire manager, available in Black (BK) and White (WT). | 90" x 3/4" x 3/8" | T-WM-90-Color |
| Elbow connector to use with wire manager, available in Black (BK) and White (WT). | 1-1/2" x 1-1/2" x 1/2" | T-WM-EC-Color |
| In-line splice connector to use with plastic wire manager, available in Black (BK) and White (WT). | 1" x 7/8" x 7/16" | T-WM-ISC-Color |
| Amplifier used to boost signal | 7" x 1-13/16" x 7/8" | T-AMP-180W |

Wire

| Description | Dimensions | Part Number |
|--|-------------|-----------------|
| 20/2 AWG stranded wire, 25 ft. spool | 1/8" (3 mm) | T-CW20G-STR-25 |
| 20/2 AWG stranded wire, 50 ft. spool | 1/8" (3 mm) | T-CW20G-STR-50 |
| 20/2 AWG stranded wire, 100 ft. spool | 1/8" (3 mm) | T-CW20G-STR-100 |
| 20/2 AWG stranded wire. Specify the number of feet needed. Sold per foot. Order minimum is 2 ft. | 1/8" (3 mm) | T-CW20G-STR-1 |
| 20/2 AWG solid wire, 25 ft. spool | 1/8" (3 mm) | T-CW20G-SOL-25 |
| 20/2 AWG solid wire, 50 ft. spool | 1/8" (3 mm) | T-CW20G-SOL-50 |
| 20/2 AWG solid wire, 100 ft. spool | 1/8" (3 mm) | T-CW20G-SOL-100 |
| 20/2 AWG solid wire. Specify the number of feet needed. Sold per foot. Order minimum is 2 ft. | 1/8" (3 mm) | T-CW20G-SOL-1 |