

# INSTALLATION INSTRUCTIONS

## PT-WPM2 SERIES

PT-WPM2-15W/PT-WPM2-20W/PT-WPM2-30W

**PORTOR**  
LIGHTING  
a PORTOR INDUSTRY brand



### READ THESE INSTRUCTIONS COMPLETELY AND CAREFULLY

#### SAFETY

THIS FIXTURE MUST BE WIRED IN ACCORDANCE WITH THE NATIONAL ELECTRICAL CODE AND APPLICABLE LOCAL CODES AND ORDINANCES. PROPER GROUNDING IS REQUIRED TO INSURE PERSONAL SAFETY. CAREFULLY OBSERVE THE GROUNDING PROCEDURE UNDER INSTALLATION SECTION. ALL WORK SHOULD BE DONE BY A QUALIFIED ELECTRICIAN.

- **RISK OF ELECTRIC SHOCK** - DISCONNECT POWER AT FUSE OR CIRCUIT BREAKER BEFORE INSTALLING OR SERVICING.
- **RISK OF PERSONAL INJURY** - FIXTURE MAY BECOME DAMAGED AND/OR UNSTABLE IF NOT INSTALLED PROPERLY. TIGHTEN ALL FIXTURE COMPONENTS TO THEIR RECOMMENDED TORQUE VALUES.

#### WARNING

- TURN OFF ELECTRICAL POWER AT FUSE OR CIRCUIT BREAKER BOX BEFORE WIRING FIXTURE TO THE POWER SUPPLY.
- TURN OFF THE POWER WHEN YOU PERFORM ANY MAINTENANCE.
- VERIFY THAT SUPPLY VOLTAGE IS CORRECT BY COMPARING IT WITH THE LUMINAIRE LABEL INFORMATION.
- ALL WIRING CONNECTIONS SHOULD BE CAPPED WITH UL APPROVED WIRE CONNECTORS.

#### CAUTION

- AVOID DIRECT EYE EXPOSURE TO THE LIGHT SOURCE WHILE IT IS ON.
- ACCOUNT FOR SMALL PARTS AND DESTROY PACKING MATERIAL, AS THESE MAY BE HAZARDOUS TO CHILDREN.
- **RISK OF BURN.** DISCONNECT POWER AND ALLOW FIXTURE TO COOL BEFORE CHANGING BULB OR HANDING FIXTURE.

### INSTALLATION (ALWAYS TURN OFF THE POWER SUPPLY FROM MAIN CIRCUIT BREAKER FIRST!)

#### Installation Option 1

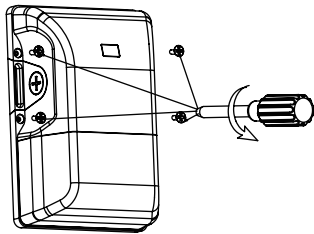

1. Loosen the 4 screws

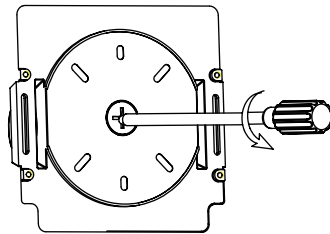

2. Remove the 1/2 end cap

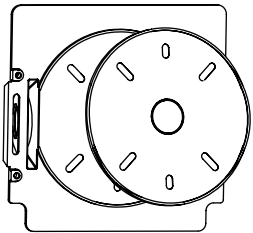

3. Peel off the yellow sticker and paste it on the round area of the bottom plate

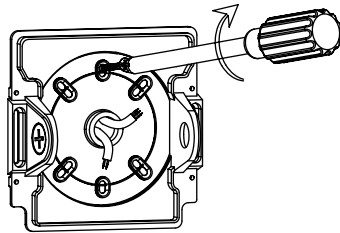

4. Fix the bottom plate on the round plate

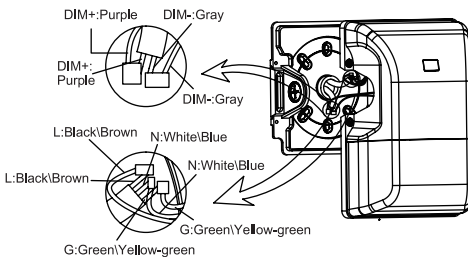

5. Make wiring connection and make sure the good protection

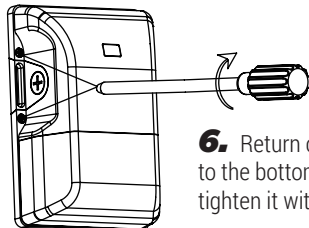

6. Return on the fixture to the bottom plate and tighten it with screws

**STANDARD WIRE:**  
L/LIVE WIRE : BLACK\BROWN;  
N/NULL WIRE : WHITE\BLUE;  
GROUND WIRE : GREEN\YELLOW-GREEN

DIM+ : PURPLE  
DIM- : GRAY

#### Installation Option 2

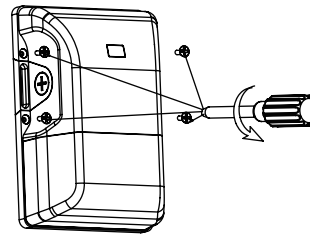

1. Loosen the 4 screws

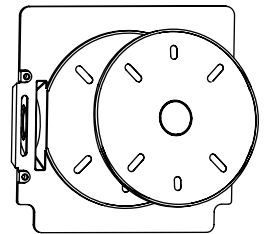

2. Peel off the yellow sticker and paste it on the round area of the bottom plate

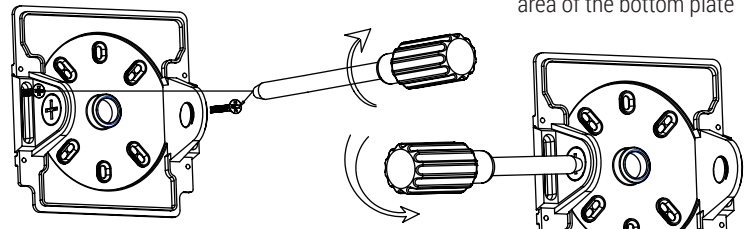

3. Screw the bottom plate on the wall

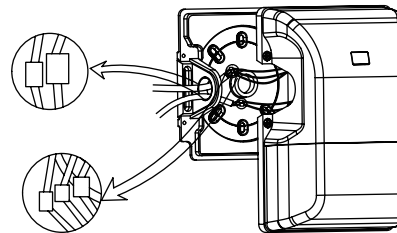

4. Remove one of the 1/2 end cap and get through wire

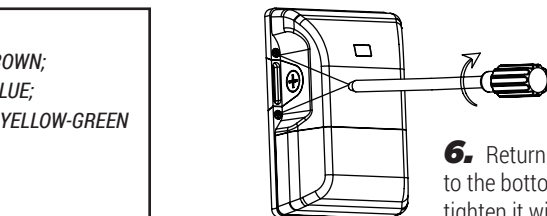

5. Make wiring connection and make sure the good protection

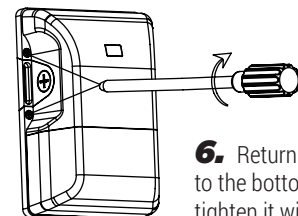

6. Return on the fixture to the bottom plate and tighten it with screws