

Catalog Number:	Project Name:	Note:	Date:	Type:
-----------------	---------------	-------	-------	-------

Portor's second generation AL2 Area Light White Series is highly energy efficient and provides advanced optical control. The ultra slim profile delivers enhanced performance for general area lighting applications. The robust die-cast housing provides excellent thermal management for longer life and can withstand everyday harsh outdoor environments.

Ideal use for parking lots, car dealerships, roadways, walkways, school campuses, shopping centers and industrial areas



NOT FOR USE AS AN UP LIGHT

CONSTRUCTION

Die-cast aluminum body combined with state of the art heat dissipation. Waterproof, built rugged for outdoor harsh conditions.

ELECTRICAL

Built with the highest quality, long lasting Universal Voltage driver 100V-27V (347V-480V optional), and water resistant LED chips.

OPTICAL SYSTEM

Comes standard with Type III optics designed to reduce glare and improve light distribution through precision formed lens optics. Type V is available.

MOUNTING

Multiple mounting options available: Slipfitter, square-pole mount, round-pole mount, u-bracket and trunnion mount.

SENSOR READY

Photocell and motion sensor available.

DIMMING

1-10V dimmable

ENERGY SAVINGS

Over 70% energy savings than traditional fixtures, low heat productions requires less maintenance and operation cost.

LISTING

UL Listed, DLC Premium Listed, RoHS, IP65 rated

WARRANTY

5 year Limited Warranty, Rated for 50,000 hours.

WATTAGE	DELIVERED LUMENS	EFFICACY
200W	28,371 @ 3000K	142 lm/W
	28,757 @ 4000K	144 lm/W
	29,143 @ 5000K	146 lm/W

TECHNICAL SPECIFICATION

CCT	3000K, 4000K, 5000K
CRI	70+
DIMMABLE	1-10V dimming
DISTRIBUTION	Type III (Standard), Type IV & V (Optional)
VOLTAGE	100V-277V (347V-480V optional)
SENSOR	Photocell and motion sensor capable
POWER FREQUENCY	50/60 Hz
POWER FACTOR	>0.9
THD	≤15%
WORKING TEMPERATURE	-40°F ~ 122°F
IP RATING	IP65 Wet Location
WARRANTY	5 year limited



ORDERING SAMPLE: PT-AL2N-200W-50K

Series	Wattage	CCT	Finish	Distribution	*Mounting (Not included)		*Accessories/Options		
					Bronze	White	Photocell	Sensor	Shield
PT-AL2N Second Generation Area Light Series	200W	30K (3000K) 40K (4000K) 50K (5000K)	Blank (Bronze) W (White)	Blank (Type III) T4 (Type IV) T5 (Type V)	SF-AL2 SPM-AL2 SAM-AL2 TM-AL2 UB-AL2-2037	SF-AL2-W SPM-AL2-W SAM-AL2-W TM-AL2-W UB-AL2-2037-W	PC PC-HV	MS-UNI-MW RC-UNI-MW (Required)	SHD-AL2-2037 SHD-AL2-2037-W

*Sold separate

Catalog Number:	Project Name:	Note:	Date:	Type:
-----------------	---------------	-------	-------	-------

DIMENSION

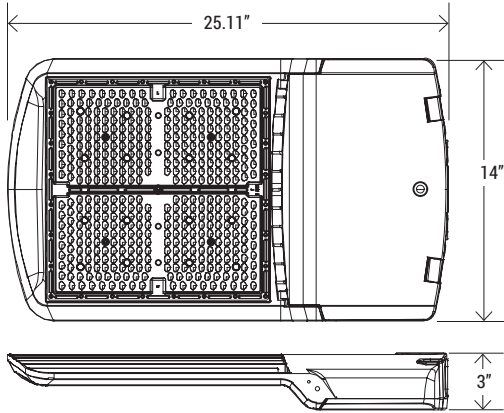

PHOTOCELL OPTION



PC
Photocell
(120V-277V)



PC-HV
Photocell (480V)

SENSOR OPTION



MS-UNI-MW
Universal Microwave Motion Sensor



RC-UNI-MW
Remote Control (Required)

SHIELD OPTION



SHD-AL2-2037
SHD-AL2-2037-W
(200W/240W)

Shield for AL Series

***MOUNTING OPTION (SOLD SEPARATELY)**



SF-AL2 (-W)
Slipfitter



SPM-AL2 (-W)
Adjustable Mount For
Square/Round Pole



SAM-AL2 (-W)
Straight Arm Mount for
Square Pole



TM-AL2 (-W)
Trunnion Mount

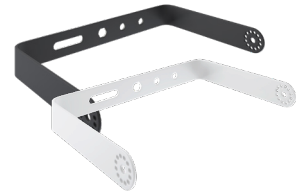

UB-AL2-2037 (-W)
U-Bracket Mount

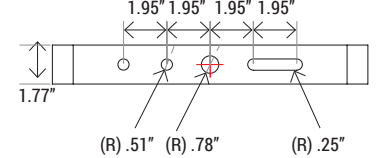
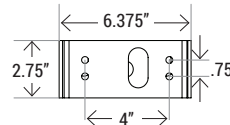
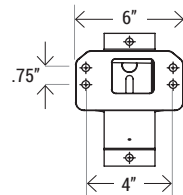
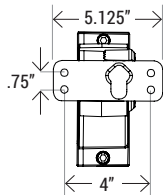
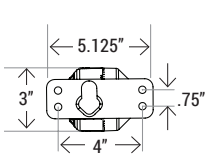
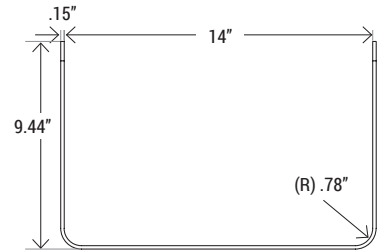
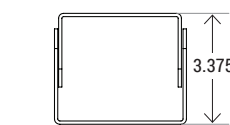
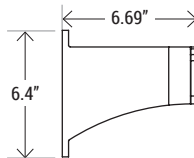
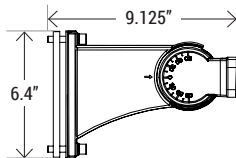
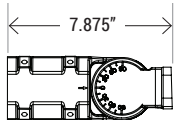

ELECTRICAL LOAD

WATTAGE	120V	208V	240V	277V	347V	480V
200W	1.68 Amp	0.96 Amp	0.83 Amp	0.72 Amp	0.57 Amp	0.42 Amp

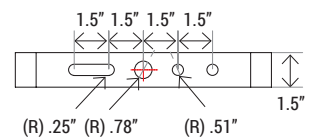
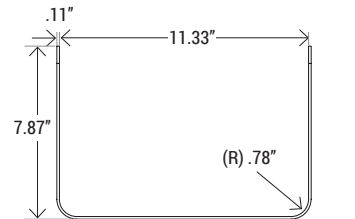

Catalog Number:	Project Name:	Note:	Date:	Type:
-----------------	---------------	-------	-------	-------

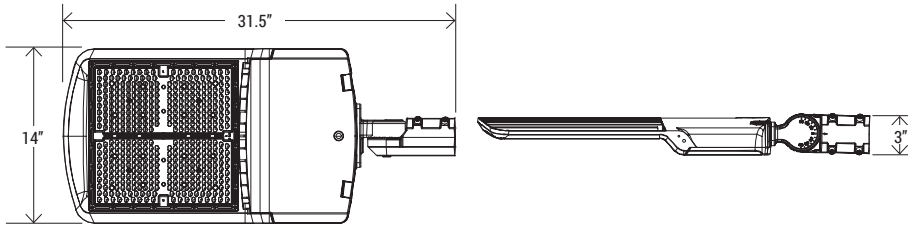

EPA	0.8 ft²
Net Weight	17.42 lbs
Gross Weight	20.72 lbs
Dimension	14" x 31.5" x 3"

B	U	G
4	0	4

***WITH SLIPFITTER MOUNTING**

CONFIGURATION	1	2 @ 180°	2 @ 90°	3 @ 90°	3 @ 120°	4 @ 90°
EPA	0.8 ft²	1.6 ft²	1.2 ft²	2.0 ft²	1.7 ft²	2.3 ft²
Net Weight	17.42 lbs	34.84 lbs	34.84 lbs	52.26 lbs	52.26 lbs	69.68 lbs

DISTRIBUTION

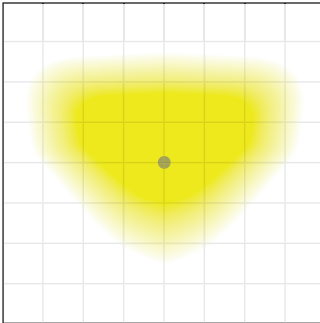

TYPE III
Type III distribution provides a wide, round pattern and yields an even light disbursement since the light projects outwards.

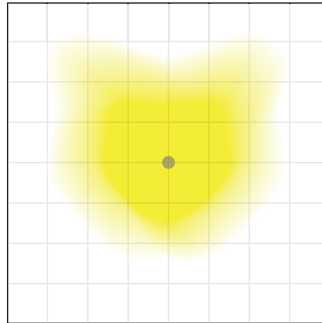

TYPE IV
Type IV has a preferred lateral width of 60° make it ideal for parking area and courtyard.

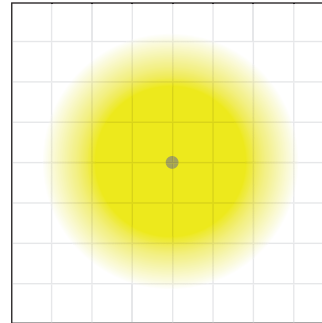

TYPE V
Type V provides central circular or square design pattern, equally across all angles from a central point.

QTY/CARTON

1

PIECE



CATALOG NUMBER	CCT	DELIVERED LUMENS	EFFICACY	DLC PRODUCT ID	CLASSIFICATION
PT-AL2N-200W	3000K	28,371	142 lm/W	S-VCP02W	PREMIUM
	4000K	28,757	144 lm/W	S-MLVBAR	
	5000K	29,143	146 lm/W	S-SM9JVN	